

Capitol 1st Floor Exhibits, Artwork

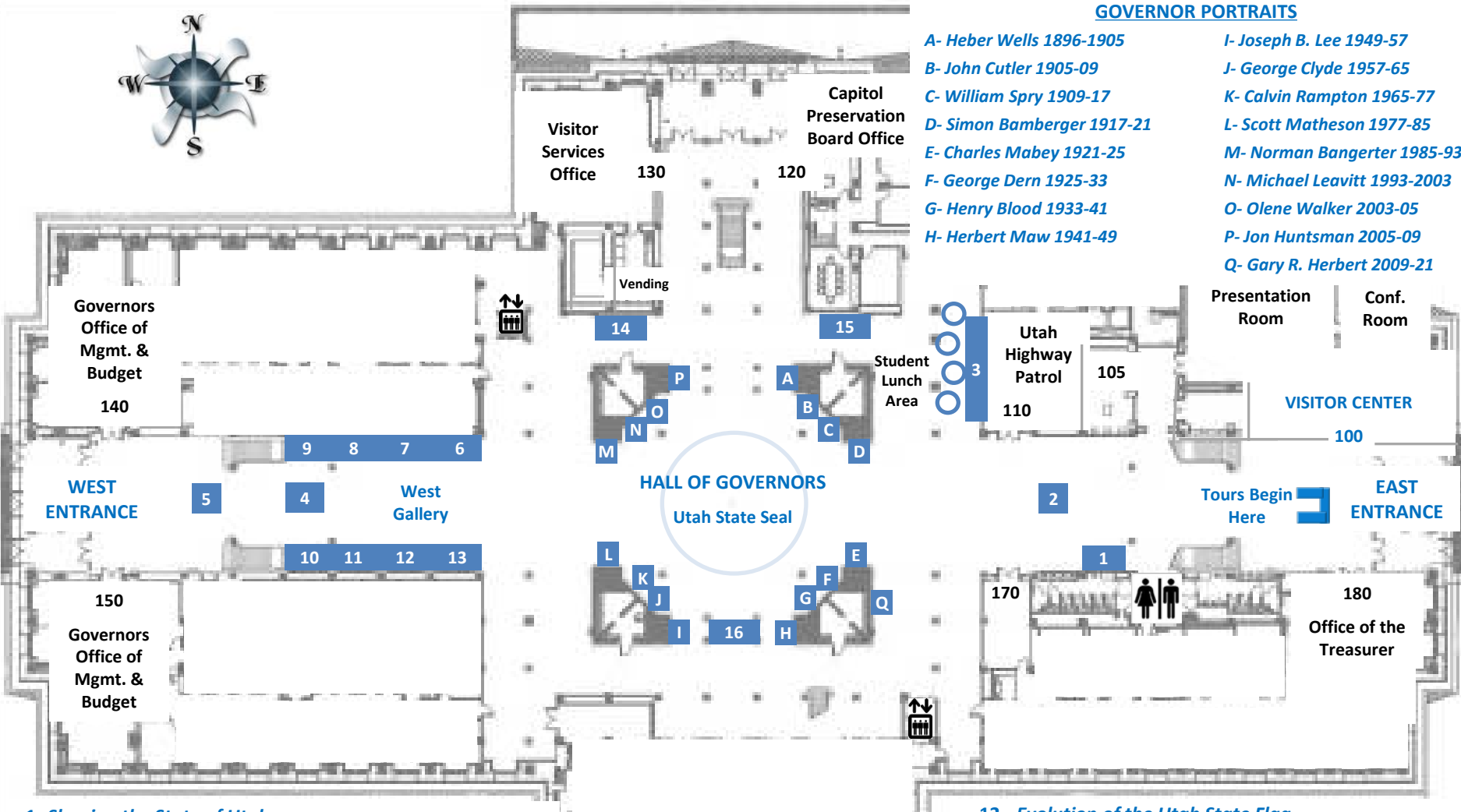

GOVERNOR PORTRAITS

A- Heber Wells 1896-1905

B- John Cutler 1905-09

C- William Spry 1909-17

D- Simon Bamberger 1917-21

E- Charles Mabey 1921-25

F- George Dern 1925-33

G- Henry Blood 1933-41

H- Herbert Maw 1941-49

I- Joseph B. Lee 1949-57

J- George Clyde 1957-65

K- Calvin Rampton 1965-77

L- Scott Matheson 1977-85

M- Norman Bangerter 1985-93

N- Michael Leavitt 1993-2003

O- Olene Walker 2003-05

P- Jon Huntsman 2005-09

Q- Gary R. Herbert 2009-21

1- *Shaping the State of Utah*

2- *Utah from Space*, 3-D Map of Utah

3- *Student Artwork Honoring the Capitol Centennial*

4- *1895, Utah Constitution*

5- *Replica of the Liberty Bell*

6- *Utah. America's Film Set.*

7- *Utah's Art Law of 1899, First in the Nation*

8- *A Paleontologist's Paradise, Natural History Museum of Utah*

9- *It All Begins with Mining*

10- *A Building Full of Treasure*

11- *The Beehive State*

12- *Evolution of the Utah State Flag*

13- *Richard K.A. Kletting, Architect of the Capitol*

14- *Jim Bridger Meets the Indians*- Minerva Teichert

15- *United States 45-Star Flag* – Gift of Serge Nelson Benson Family to State of Utah

16- *Celebrating 200 Years of Greek Independence 1821-2021*

Capitol 2nd Floor Exhibits, Artwork

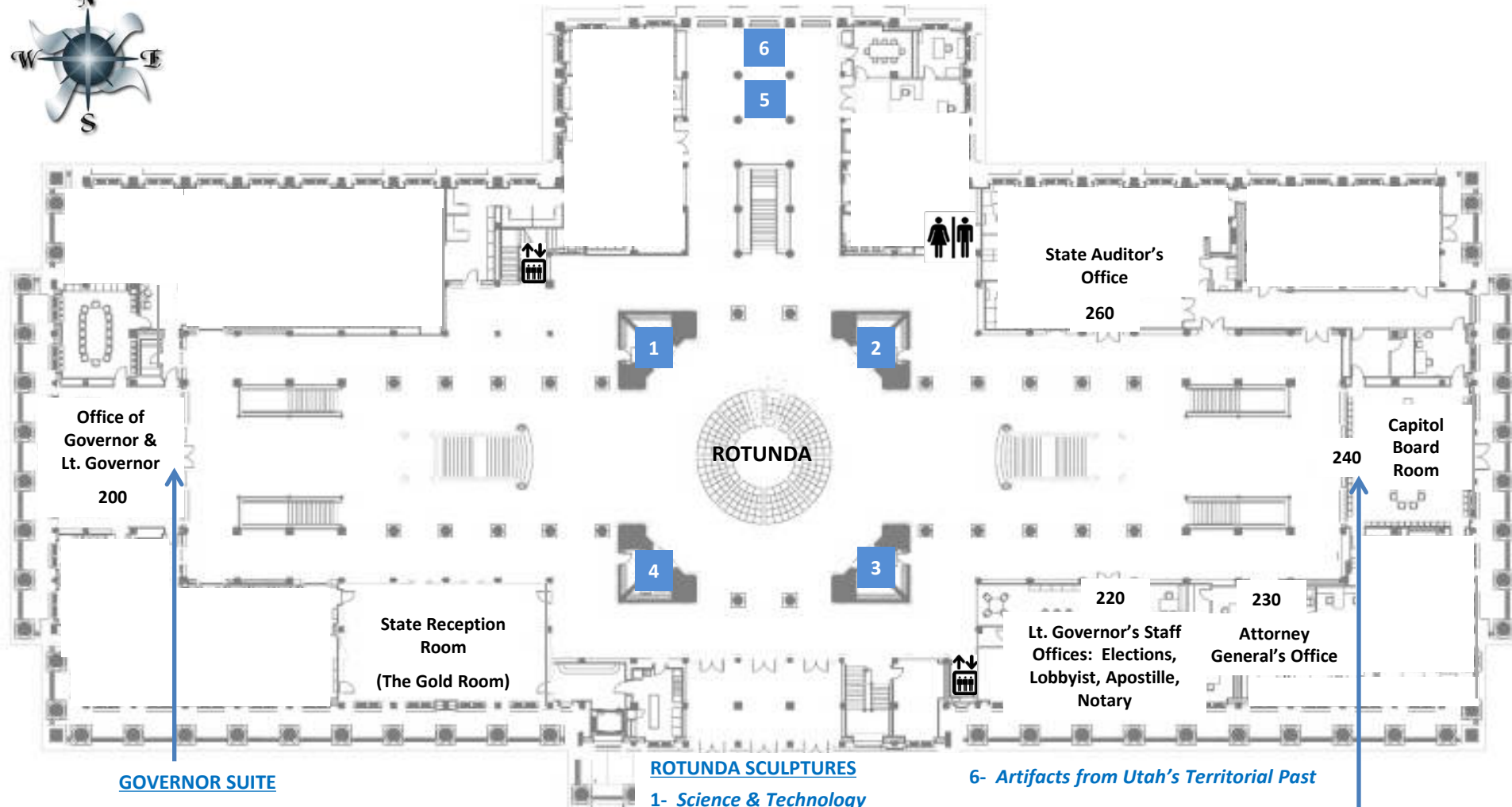

GOVERNOR SUITE

Bingham Canyon 1 and 2

Mystery of the Desert

Painted by H.L.A. "Harry" Culmer

Twilight Valley by Bradley Aldridge

ROTUNDA SCULPTURES

1- *Science & Technology*

2- *Land & Community*

3- *Immigration & Settlement*

4- *Arts & Education*

5- *Statue of Brigham Young*

Created by Daub, Firmin, and Hendrickson

6- Artifacts from Utah's Territorial Past

CAPITOL BOARD ROOM

Portrait Group of State Capitol Commission

Painted by John "Will" Clawson

Capitol 3rd Floor Exhibits, Artwork



SENATE CHAMBER MURALS

Utah Lake- Lee Greene
Richards & Alma B. Wright

*Orchard Along the Foothills
(Northern Utah)*- Keith Bond

*My Ancestral Home (Southern
Utah)*- Keith Bond

3rd FLOOR GALLERY

Exhibits to follow

HOUSE CHAMBER MURALS

Dream of Brigham Young-
Vincent Aderente

*Jim Bridger and the
Discovery of the Great Salt
Lake*- Alonzo Earl Foringer

Seraph Young Votes- David
Koch

*Engen Brothers Bring Skiing
to Utah*- David Koch

6 350 5
House of
Representatives Office

3rd Floor Gallery

Senate
Office
320

1

2

SUPREME COURT CHAMBER MURAL

*Natural Bridge (Caroline
Bridge)*- H.L.A. "Harry"
Culmer

*

300

3

4



- 1- Photograph of Individual Senators
- 2- Photograph of the Senate President

3- Photograph of the Utah Supreme
Court Justices

4- Photograph of the Chief Justice

- 5- Photograph of the Speaker of the House
- 4- Photograph of Individual Representatives

* Dr. Martha Hughes Cannon Statue for
Statuary Hall, Washington, D.C.

Capitol 4th Floor Exhibits, Artwork Rotunda Murals



4th FLOOR GALLERY

Thrive 125, Celebrating the 125th Anniversary of Utah's First Legislature - West wing

Prize Photography from the 2021 Utah State Fair- East wing

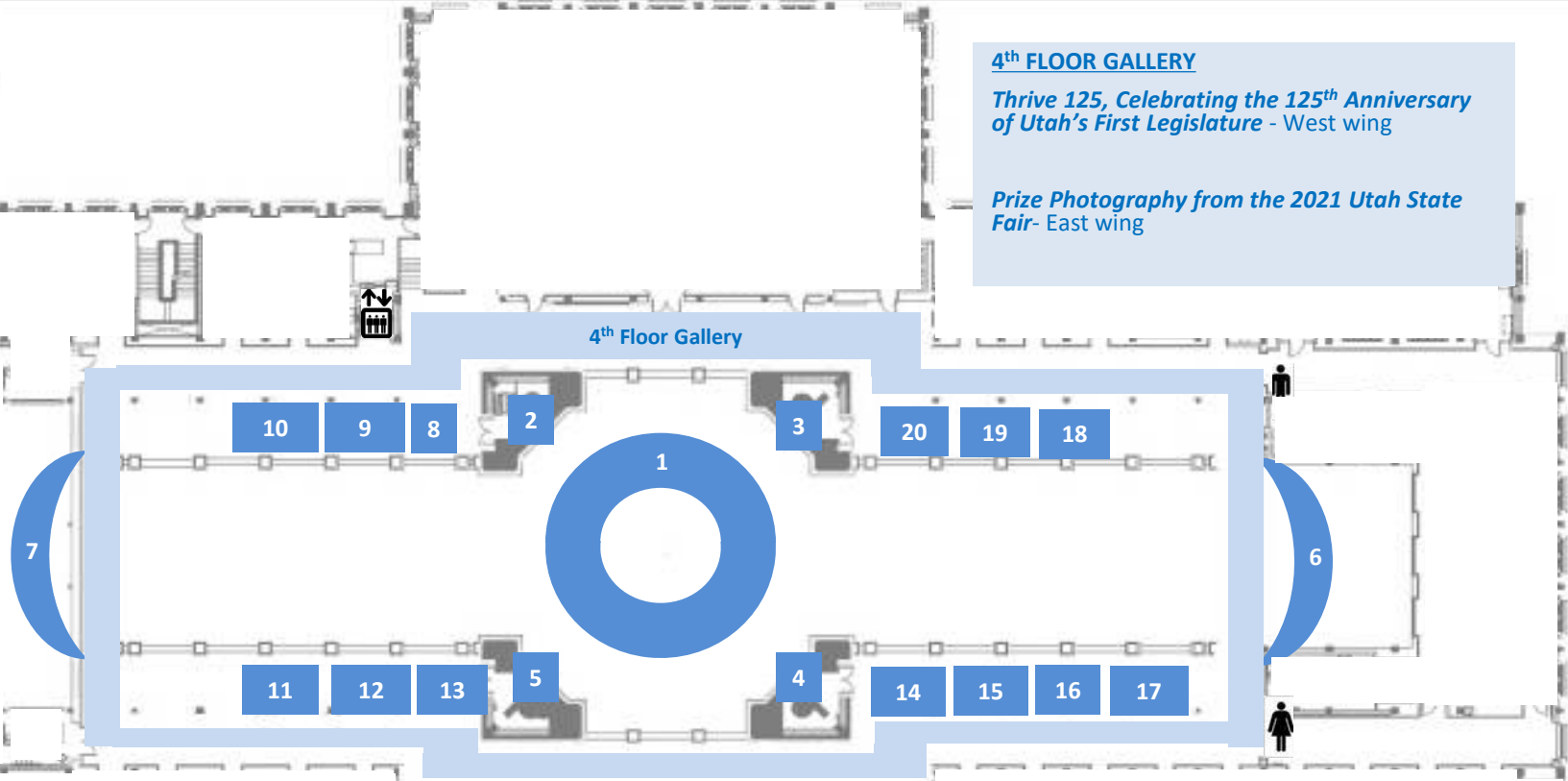

1- CYCLORAMA— by Lee Greene Richards

Naming of Ensign Peak

Social Gathering in the Old Bowery

Gulls Save the Wheat Fields

Driving the Golden Spike

Advent of irrigation by Pioneers

Peace with the Indians

Pony Express and the Stagecoach

General Connor Inaugurates Mining

PENDENTIVES— by Lee Greene Richards

2- Fremont First Sees Great Salt Lake 1843

3- Peter Skene Ogden at Ogden River 1828

4- Brigham Young and Pioneers Entering the Valley

5- Father Escalante Discovers Utah Lake 1776

LUNETTES— by Girard Hale, Gilbert White

6- Reclaiming the Desert by Irrigation

7- The Arrival of the Pioneers in the Great Salt Lake Valley in 1847



8- Simon Bamberger- T. Knaphus

9- Thrive 125 - artifacts

10- Emmeline B. Wells- C. Dallin

11- Maurice Warshaw- A. Fairbanks

12- Thrive 125 - artifacts

13- David Abbott (AB) Jenkins- J. Andersen

14- Philo T. Farnsworth- J. Avati

15- Artifacts from Early Capitol History

16- Chief John Duncan- M. Malin

17- Unca Sam- M. Malin

18- Brigadier General Richard Whitehead Young— M. Cummings

19- Mary Holiday Black: Master Diné Basket Weaver

20- Abraham Lincoln- G. Riswold